



Uni-block system for low and medium temperature refrigeration

SB



Reciprocating
compressor

For roof mounted installation in small and medium sized cold rooms

- › Rapid mounting on the roof of the cold room
- › Ceiling assembly leaves the space inside the cold room completely free
- › The white colour of the evaporator blends unobtrusively with the cold room walls
- › Extremely fast to assemble, reducing installation time and cost
- › Best surface-to-capacity ratio



Installation type

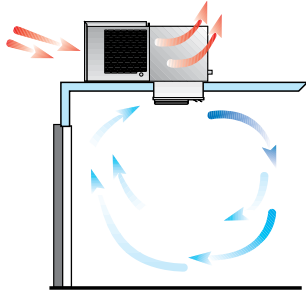

Low temperature refrigeration				BSB	010DA11XX	117DA11XX	220DB11XX	330DB11XX	440DB11XX	545DB11XX	550DB11XX
Refrigerating capacity	Low temperature	R-452A	Nom	kW	0.628 (1)	1.162 (1)	1.699 (1)	2.596 (1)	3.097 (1)	3,890 (1)	4,849 (1)
Dimensions	Unit	Height x Width x Depth		mm	525 x 430 x 771	506 x 620 x 719	540 x 820 x 809	645 x 820 x 929	760 x 920 x 1,042		
	Packed unit	Height x Width x Depth		mm	690 x 540 x 830	660 x 730 x 790	690 x 930 x 880	800 x 930 x 1,000		850 x 1,100 x 1,100	
Weight	Unit			kg	48	68	87	102	120	162	165
	Packed unit			kg	61	82	108	124	149	195	198
Compressor	Type	Hermetic Reciprocating									
	Nominal power			kW	0.6	1.3	1.5	2.2	2.6	3	3.7
	Starting method	Direct									
Operation range	Cold room temperature Min. ~Max.			°C	-25 ~ -15						
Refrigerant	Type	R-452A									
	GWP	2,141.0									
Evaporator	Air flow			m³/h	500	550	1,100	2,300		3,450	
	Air throw			m	3 (3)	4 (3)		10 (3)			
Condenser	Air flow			m³/h	400	750	1,400	1,500	3,150	3,200	
Defrost	Hot gas										
Power supply	Voltage / Phase / Frequency			V/Hz	230 / 1~ / 50			400 / 3N~ / 50			

Medium temperature refrigeration				MSB	005EA 11XX	106EA 11XX	107EA 11XX	210EA 11XX	212EB 11XX	315EB 11XX	320EB 11XX	425EB 11XX	530EB 11XX
Refrigerating capacity	Medium temperature	R-134a	Nom	kW	0.857 (2)	1.120 (2)	1.338 (2)	1.799 (2)	2.022 (2)	3.282 (2)	3.550 (2)	3.774 (2)	4.871 (2)
Dimensions	Unit	Height x Width x Depth		mm	525x430x771	506 x 620 x 719		540 x 820 x 809		645 x 820 x 929		760x920x1,042	785x1,075x1,046
	Packed unit	Height x Width x Depth		mm	690x540x830	660 x 730 x 790		690 x 930 x 880		800 x 930 x 1,000		880x1,100x1,100	920x1,200x1,200
Weight	Unit			kg	42	59	74	75	92	110	151	151	
	Packed unit			kg	55	73	95	96	114	139	184	184	
Compressor	Type	Hermetic Reciprocating											
	Nominal power			kW	0.5	0.6	0.7	0.9	1.7	2.2	2.6	2.9	3.7
	Starting method	Direct											
Operation range	Cold room temperature Min. ~Max.			°C	-5 ~ -10								
Refrigerant	Type	R-134a											
	GWP	1,430.0											
Evaporator	Air flow			m³/h	500	550	1,100		2,300		3,450		
	Air throw			m	3 (3)	4 (3)		10 (3)					
Condenser	Air flow			m³/h	400	750	1,400		1,500		3,100	3,200	
Defrost	Hot gas												
Power supply	Voltage / Phase / Frequency			V/Hz	230 / 1~ / 50				400 / 3N~ / 50				

(1) When normally running: -20°C / +30°C

(2) When normally running: 0°C / +30°C

(3) Use air throw as a base. Air throw is affected by many factors such as height of room, product storage, location of evaporator, etc. Contains Fluorinated greenhouse gases

Daikin Europe N.V. Naamloze Vennootschap · Zandvoordestraat 300 · 8400 Oostende · Belgium · www.daikin.eu · BE 0412 120 336 · RPR Oostende (Responsible Editor)

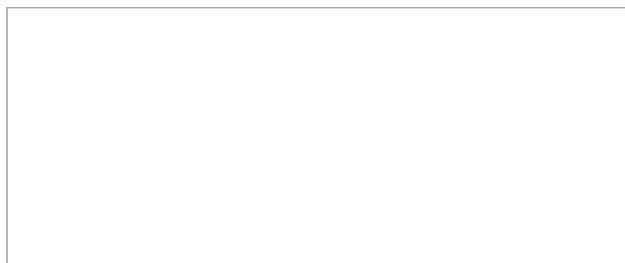

ECPEN19-832

10/18



The present leaflet is drawn up by way of information only and does not constitute an offer binding upon Daikin Europe N.V. Daikin Europe N.V. has compiled the content of this leaflet to the best of its knowledge. No express or implied warranty is given for the completeness, accuracy, reliability or fitness for particular purpose of its content and the products and services presented therein. Specifications are subject to change without prior notice. Daikin Europe N.V. explicitly rejects any liability for any direct or indirect damage, in the broadest sense, arising from or related to the use and/or interpretation of this leaflet. All content is copyrighted by Daikin Europe N.V.