



Bi-block system for low and medium temperature refrigeration

GS



Reciprocating
compressor

Condensing unit for wall mounted installation

- › Wall mounted condensing unit and ceiling mounted evaporator
 - › Extremely rapid mounting
 - › Best surface-to-capacity ratio
 - › Low sound levels thanks to optional compressor compartment soundproofing
- › New generation control panel: possibility to connect it to classic remote management systems or to a Modbus system

Installation type

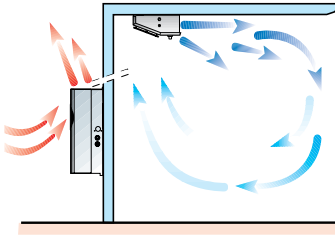

Low temperature refrigeration				SB.BGS	110P			112P			117P			218P			220P			330P		
					1D	2D	3D	1D	2D	3D	1D	2D	3D	1D	2D	3D	1D	2D	3D	1D	2D	3D
Refrigerating capacity	Low temperature	R-452A	Nom	kW	0.679 (1)			0.889 (1)			1.080 (1)			1.336 (1)			1.688 (1)			2.349 (1)		
Dimensions	Condensing unit	Height x Width x Depth		mm				735 x 400 x 280						830 x 620 x 280			830 x 620 x 350					
	Evaporator unit	Height x Width x Depth		mm				215 x 654 x 410						215 x 1,074 x 410			215 x 1,654 x 410					
	Packed condensing unit	Height x Width x Depth		mm				955 x 490 x 610						1,050 x 490 x 740			1,050 x 600 x 740					
	Packed evaporator unit	Height x Width x Depth		mm				470 x 260 x 780						470 x 260 x 1,200			470 x 260 x 1,780					
Weight	Condensing unit			kg	46			54						64			84					
	Evaporator unit			kg				13						19			28					
	Packed condensing unit			kg	57			65						76			98					
	Packed evaporator unit			kg				15						21			31					
Compressor	Type				Hermetic Reciprocating																	
	Nominal power			kW	0.74			0.9			1.3			1.5			2.2					
	Starting method				Direct																	
Operation range	Cold room temperature	Min. ~Max.		°C	-25 ~-15																	
Refrigerant	Type				R-452A																	
	GWP				2,141																	
Evaporator	Air flow			m ³ /h				600						1,200			1,800					
	Air throw			m							4 (3)											
Condenser	Air flow			m ³ /h				600						1,200			1,500					
Defrost					Hot gas																	
Piping length			m	2.5	5	10	2.5	5	10	2.5	5	10	2.5	5	10	2.5	5	10	2.5	5	10	
Power supply	Voltage / Phase / Frequency			V/Hz	230 / 1~ / 50												400 / 3N~ / 50					

Medium temperature refrigeration				SB.MGS	103P			105P			106P			107P			110P			211P			212P			213P			315P			320P		
					1E	2E	3E	1E	2E	3E	1E	2E	3E	1E	2E	3E	1E	2E	3E	1E	2E	3E	1E	2E	3E	1E	2E	3E	1E	2E	3E	1E	2E	3E
Refrigerating capacity	Medium temperature	R-134a	Nom	kW	0.855 (2)			0.978 (2)			1.120 (2)			1.315 (2)			1.351 (2)			1.806 (2)			2.034 (2)			2.175 (2)			3.079 (2)			3.351 (2)		
Dimensions	Condensing unit	Height x Width x Depth		mm				735 x 400 x 280									830 x 620 x 280			830 x 620 x 350														
	Evaporator unit	Height x Width x Depth		mm				215 x 654 x 410									215 x 1,074 x 410			215 x 1,654 x 410														
	Packed condensing unit	Height x Width x Depth		mm				955 x 490 x 610									1,050 x 490 x 740			1,050 x 600 x 740														
	Packed evaporator unit	Height x Width x Depth		mm				470 x 260 x 780									470 x 260 x 1,200			470 x 260 x 1,780														
Weight	Condensing unit			kg	42			43			46			54						64			77			79								
	Evaporator unit			kg				13									19			28														
	Packed condensing unit			kg	53			54			57			65						76			91			93								
	Packed evaporator unit			kg				15									19			31														
Compressor	Type				Hermetic Reciprocating																													
	Nominal power			kW	0.4			0.5			0.4			0.7			0.9			1.7			2			2.2			2.6					
	Starting method				Direct																													
Operation range	Cold room temperature	Min. ~Max.		°C	-5 ~-10																													
Refrigerant	Type				R-134a																													
	GWP				1,430																													
Evaporator	Air flow			m ³ /h				600									1,200			1,800														
	Air throw			m										4 (3)																				
Condenser	Air flow			m ³ /h				600									1,200			1,500														
Defrost					Electric																													
Piping length			m	2.5	5	10	2.5	5	10	2.5	5	10	2.5	5	10	2.5	5	10	2.5	5	10	2.5	5	10	2.5	5	10	2.5	5	10	2.5	5	10	
Power supply	Voltage / Phase / Frequency			V/Hz	230 / 1~ / 50												400 / 3N~ / 50																	

(1) When normally running: -20°C / +30°C

(2) When normally running: 0°C / +30°C

(3) Use air throw as a base. Air throw is affected by many factors such as height of room, product storage, location of evaporator, etc.

Contains Fluorinated greenhouse gases

Daikin Europe N.V. Naamloze Vennootschap · Zandvoordestraat 300 · 8400 Oostende · Belgium · www.daikin.eu · BE 0412 120 336 · RPR Oostende (Responsible Editor)

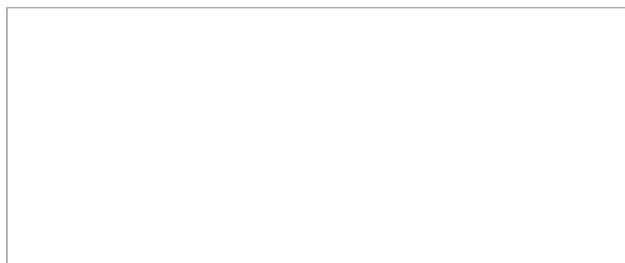

The present leaflet is drawn up by way of information only and does not constitute an offer binding upon Daikin Europe N.V. Daikin Europe N.V. has compiled the content of this leaflet to the best of its knowledge. No express or implied warranty is given for the completeness, accuracy, reliability or fitness for particular purpose of its content and the products and services presented therein. Specifications are subject to change without prior notice. Daikin Europe N.V. explicitly rejects any liability for any direct or indirect damage, in the broadest sense, arising from or related to the use and/or interpretation of this leaflet. All content is copyrighted by Daikin Europe N.V.

ECPEN17-831

10/17

